



ULTRA 18V

MULTISTAGE electric pumps

USES

Pumping of clean non-loaded fluids in the domestic, agricultural and industrial sectors; pressurizing systems; irrigation; drinking and glycol water; water treatment; food industry; heating and air conditioning; washing system.

ADVANTAGES

Closed coupled and compact; silent; excellent efficiency that allows a reduction of running cost and powers; economical; over-dimensioned bearings for longer life of machines; intermediate shaft guiding stage for concentricity of rotation.

CONSTRUCTION FEATURES

Capacity: up to 26 m³/h; total Head: up to 125 m; maximum working pressure; 15 bar; maximum liquid temperature: from 5 up to 35 °C; ambient temperature; up to 40 °C.

MOTOR

2 Pole induction Motor; single Phase 230V - 50 Hz with thermal protector; three phase 230 - 400V - 50 Hz; insulation class F; protection degree IP 44.

MATERIALS

Flanged section pump body: cast iron; flanged delivery pump body: cast iron; shell: AISI 304 chromo-nickel steel. Impellers, diffusers, mechanical seal disc holder: Noryl® ; pump shaft: AISI 303 chromo-nickel steel; motor bracket: cast iron; mechanical seal: ceramic-graphite up to 6 stages - graphite-silicon carbide from 7 stages; intermediate shaft guiding stage bush: ceramic-tungsten carbide; pump body gasket: EPDM.



Dimensions

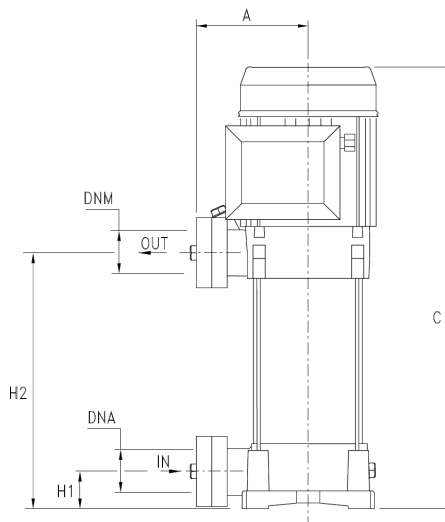
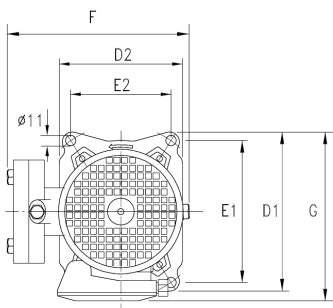

U 18 V - 550 / 6 T

- Three-phase
- No. of impellers
- Nominal Power HPx100
- Vertical
- Stainless steel
- Nominal flow-rate m³/h
- Type ULTRA

TYPE	DIMENSIONS										DNA	DNM
	A	C	D1	D2	E1	E2	F	G	H1	H2		
U 18V-250/3 T	135	451	204	162	178,5	125	229	215	50	213,5	2"G	1"1/2G
U 18V-400/4 T	135	534	204	162	178,5	125	229	230	50	251		
U 18V-450/5 T	135	605	204	162	178,5	125	235	250	50	288,5		
U 18V-550/6 T	135	642	204	162	178,5	125	235	250	50	326		
U 18V-750/8 T	135	675	204	162	178,5	125	235	250	50	363,5		
U 18V-900/9 T	135	708	204	162	178,5	125	235	250	50	401		

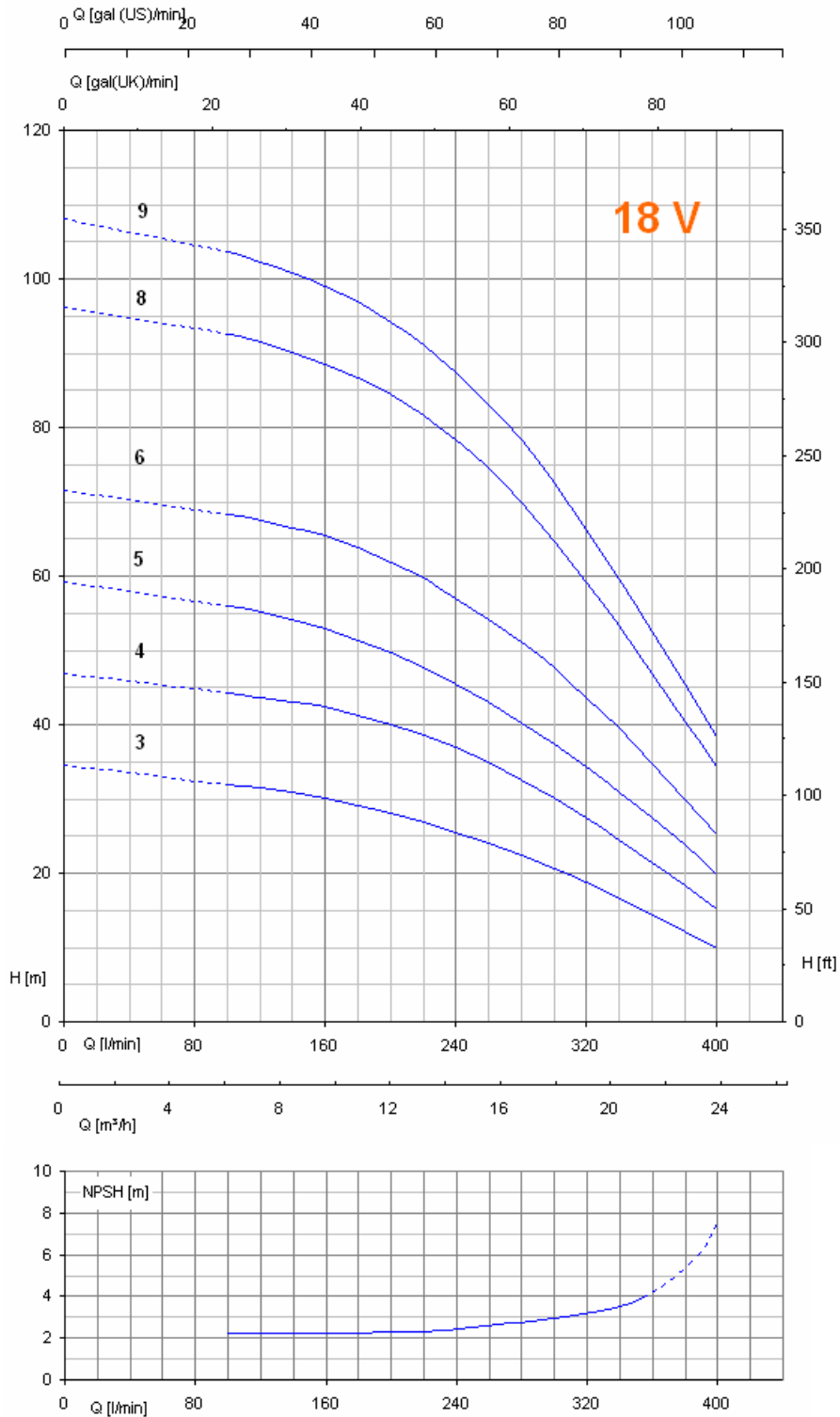

Technical data



TYPE	P ₂		P ₁ (kW)	AMPERE	Q (m ³ /h – l/min)											
					0	6	8,4	10,8	13,2	14,4	15,6	18	20,4	22,8	26,4	
3~				3~	0	100	140	180	220	240	260	300	340	380	440	
230 / 400 V – 50 Hz	(HP)	(kW)	3~	3x400 50Hz	H (m)											
U 18V-250/3 T	2,5	1,8	2,19	4,3	34.5	32.0	30.9	29.1	26.8	25.5	24.1	20.7	16.5	12.2	10.0	
U 18V-400/4 T	4.0	2.9	2.99	5.5	46.8	44.2	43.1	41.3	38.6	36.9	35	30.1	24.5	18.4	15.2	
U 18V-450/5 T	4.5	3.3	3.68	6.6	59.1	55.9	54.1	51.3	47.7	45.5	43.0	37.3	30.9	23.9	19.8	
U 18V-550/6 T	5.5	4.0	4.51	8.7	71.6	68.2	66.5	63.8	59.7	57.0	54.2	47.6	39.5	29.9	25.2	
U 18V-750/8 T	7.5	5.5	6.0	10.7	96.1	92.6	90.1	86.6	81.6	78.3	74.5	64.7	53.3	40.5	34.3	
U 18V-900/9 T	9.0	6.6	7.17	12.8	108.0	103.6	100.8	96.9	91.1	87.5	83.0	72.6	59.6	45.5	38.3	