

# Sprinkler

## Round Type Sprinkler

Paradise **Round type** sprinkler is designed to have the exposed part to be installed near the ceiling and best suited for use in hotel, hospital and office building where the look has to be considered.

### Operation

When the rated temperature is reached, the alloy melts and it causes the fuse holder to drop. Water is then discharged in the designated pattern.

### Specification

Model No.	FH321	FH322
Working Temperature	72°C	105°C
Max. Ambient Temperature	39°C	67°C
Surface Finishing	Nickel-Chrome Plated	
Connection Screw Size	15A (PT 1/2 " )	
Orifice Size	ø 12.2mm	
Test Pressure	25kgf/cm <sup>2</sup>	
Flow Rate	80ℓ /min-1 kgf/cm <sup>2</sup> (K=80)	
Weight	18.5kg/Box	
Packaging	100Ea	



Round Type

### Assembly Diagram

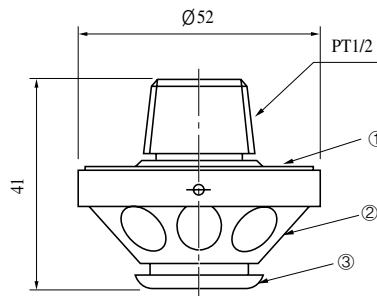

NO	Part	Material
1	Frame	Forged Brass
2	Deflector	Forged Brass
3	Fuse Holder	Copper Plate

### Installation Diagram

